

ECAI 2012

20TH EUROPEAN CONFERENCE ON ARTIFICIAL INTELLIGENCE

Workshops, Tutorials, RuleML, STAIRS Schedule

ECAI 2012

20TH EUROPEAN CONFERENCE ON ARTIFICIAL INTELLIGENCE

Day Program: Monday 27th August

Morning Session

<i>ID</i>	<i>Title</i>	<i>Location</i>	<i>Schedule</i>
T2	Cognitive Robotics (M. Beetz)	Polytech SC104	9:00-12:30
T5	Submodularity in Artificial Intelligence (Krause, Jegelka)	Polytech SC005	9:00-12:30
T6	Logics for multi-agent systems (L. Van der Torre)	Polytech SC003	9:00-12:30
WS1	Spatio-Temporal Dynamics (STeDy 2012)	IAE TD Room 04	9:15-12:30
WS6	Workshop on Configuration (ConfWS'12)	IAE TD Room 06	9:00-12:45
WS11	2nd International Workshop on Agent-based Modeling for PoLicy Engineering	Polytech TD014	9:00-13:00
WS16	1st International Workshop of Artificial Intelligence and Netmedicine (NetMed)	IAE TD Room 07	8:45-12:30
WS18	Citi-Sen2012	Polytech TD022	9:00-13:00
WS19	12th International Workshop On Computational Models of Natural Argument (CMNA 12)	Polytech TD114	9:15-12:30
WS20	Workshop on AI Problems and Approaches for Intelligent Environments (AI@IE 2012)	Building 5 TD5.13	10:30-12:30
WS21	SAMAI: Similarity and Analogy-based Methods in AI	Building 5 TD5.14	9:00-12:30
WS23	Artificial Intelligence meets the Web of Data (AImWD)	Polytech TD013	9:00-12:40
WS25	6th Multidisciplinary Workshop on Advances in Preference Handling	Polytech SC004	9:00-12:50
WS31	COmbining COnstraint solving with MIning and LEarning (CoCoMile)	Polytech TD011	9:00-13:00
WS33	Computer Games Workshop at ECAI 2012	Polytech TD012	9:00-12:30
WS36	Machine Learning for Interactive Systems (MLIS): Bridging the Gap Between Language, Motor Control and Vision	Polytech TD115	9:15-12:30
WS40	Computational Creativity, Concept Invention, and General Intelligence 2012	Polytech SC105	9:15-12:15
WS42	BNC'12: Belief change, Nonmonotonic reasoning, and Conflict resolution	Polytech TD015	9:00-12:00

ECAI 2012

20TH EUROPEAN CONFERENCE ON ARTIFICIAL INTELLIGENCE

Day Program: Monday 27th August

Afternoon Session

<i>ID</i>	<i>Title</i>	<i>Location</i>	<i>Schedule</i>
T1	Unity in diversity: the breadth and depth of Machine Learning explained for AI researchers (P. Flach)	Building 5 Amphi 5.02	14:00-17:30
WS1	Spatio-Temporal Dynamics (STeDy 2012)	IAE TD Room 04	14:00-18:00
WS2	13th International Workshop on Computational Logic in Multi-Agent Systems (CLIMA XIII)	Polytech SC003	14:00-17:00
WS3	Ubiquitous Data Mining (UDM)	Polytech TD022	14:00-18:00
WS6	Workshop on Configuration (ConfWS'12)	IAE TD Room 06	14:00-17:00
WS11	2nd International Workshop on Agent-based Modeling for PoLicy Engineering	Polytech TD014	14:00-17:30
WS14	Active and Incremental Learning (AIL)	Polytech SC005	13:45-18:00
WS16	1st International Workshop of Artificial Intelligence and Netmedicine (NetMed)	IAE TD Room 07	14:30-16:30
WS19	12th International Workshop On Computational Models of Natural Argument (CMNA 12)	Polytech TD114	14:30-18:00
WS20	Workshop on AI Problems and Approaches for Intelligent Environments (AI@IE 2012)	Building 5 TD5.13	13:30-17:30
WS21	SAMAI: Similarity and Analogy-based Methods in AI	Building 5 TD5.14	14:00-18:30
WS23	Artificial Intelligence meets the Web of Data (AIImWD)	Polytech TD013	14:30-15:30
WS25	6th Multidisciplinary Workshop on Advances in Preference Handling	Polytech SC004	14:00-18:00
WS31	COMbining CONstraint solving with MIning and LEarning (CoCoMile)	Polytech TD011	14:30-18:00
WS33	Computer Games Workshop at ECAI 2012	Polytech TD012	14:00-17:00
WS36	Machine Learning for Interactive Systems (MLIS): Bridging the Gap Between Language, Motor Control and Vision	Polytech TD115	14:00-17:30
WS39	Diagnostic REASONing: Model Analysis and Performance (DREAMAP)	Polytech SC104	14:00-18:00
WS40	Computational Creativity, Concept Invention, and General Intelligence 2012	Polytech SC105	13:45-18:00
WS42	BNC'12: Belief change, Nonmonotonic reasoning, and Conflict resolution	Polytech TD015	14:00-17:00

ECAI 2012

20TH EUROPEAN CONFERENCE ON ARTIFICIAL INTELLIGENCE

Day Program: Tuesday 28th August

Morning Session

<i>ID</i>	<i>Title</i>	<i>Location</i>	<i>Schedule</i>
T7	Preference reasoning and aggregation (Rossi, Venable, Walsh)	Building 5. Amphi 5.02	9:00-12:30
WS1	Spatio-Temporal Dynamics (STeDy 2012)	IAE TD Room 04	9:00-12:30
WS2	13th International Workshop on Computational Logic in Multi-Agent Systems (CLIMA XIII)	Polytech SC003	9:00-12:30
WS8	1st European Workshop on Chance Discovery and Data Synthesis	Polytech TD012	9:15-12:20
WS9	7th International and ECAI 2012 Workshop on Explanation-aware Computing (ExaCt 2012)	Polytech TD114	9:00-12:30
WS10	5th International Workshop on Evolutionary and Reinforcement Learning for Autonomous Robot Systems (ERLARS 2012)	Polytech SC005	9:00-12:00
WS12	Algorithmic issues for inference in graphical models	IAE Room TD 07	9:15-12:30
WS13	What can FCA do for Artificial Intelligence (FCA4AI)	Polytech TD013	9:00-13:00
WS17	8th Workshop on Knowledge Engineering and Software Engineering (KESE2012)	Polytech TD022	8:30-12 :50
WS22	AI for Knowledge Management	IAE Room TD 06	8:30-12:00
WS24	RDA2 - Rights and Duties of Autonomous Agents	Polytech TD014	9:00-12:35
WS26	JIMSE: Joint workshops on Intelligent Methods for Software System Engineering	Building 16 TD16.46	9:00-12:00
WS28	Planning to Learn (PlanLearn 2012)	Building 16 TD16.50	9:00-12:00
WS29	Cooking with Computers (CwC)	Polytech SC004	9:00-12:30
WS30	Preference Learning: Problems and Applications in Artificial Intelligence (PL-12)	Building 5 Amphi 5.03	8:30-13:00
WS32	Acquisition, Representation and Reasoning with Contextualized Knowledge, 4th International Workshop (ARCOE-12)	Polytech TD011	9:00-12:30
WS34	WL4AI: Weighted Logics for AI	Polytech TD115	8:30-12:40
WS35	3rd International Workshop on Combinations of Intelligent Methods and Applications (CIMA-12)	Polytech SC104	9:00-12:30
WS37	3rd International Workshop on Artificial Intelligence and Logistics (AILog)	Polytech SC105	9:00-12:00
WS38	Workshop on Artificial Intelligence for Telecommunications and Sensors Networks (WAITS)	IAE Room TD 05	9:00-12:45
WS44	Intelligent Agents in City Simulations and Smart Cities	Polytech TD015	9:00-12:30

ECAI 2012

20TH EUROPEAN CONFERENCE ON ARTIFICIAL INTELLIGENCE

Day Program: Tuesday 28th August

Afternoon Session

<i>ID</i>	<i>Title</i>	<i>Location</i>	<i>Schedule</i>
T3	Preference Learning (Hüllermeier, Fuernkranz)	Building 5. Amphi 5.03	14:00-17:00
T4	Constraint Reasoning (Lecoutre, Roussel)	Building 5. Amphi 5.02	14:00-17:00
WS2	13th International Workshop on Computational Logic in Multi-Agent Systems (CLIMA XIII)	Polytech SC003	14:00-17:00
WS8	1st European Workshop on Chance Discovery and Data Synthesis	Polytech TD012	14:00-17:00
WS10	5th International Workshop on Evolutionary and Reinforcement Learning for Autonomous Robot Systems (ERLARS 2012)	Polytech SC005	14:00-17:00
WS12	Algorithmic issues for inference in graphical models	IAE Room TD 07	14:00-16:45
WS13	What can FCA do for Artificial Intelligence (FCA4AI)	Polytech TD013	14:25-17h00
WS22	AI for Knowledge Management	IAE Room TD 06	13:40-17:00
WS24	RDA2 - Rights and Duties of Autonomous Agents	Polytech TD014	14:00-17:00
WS26	JIMSE: Joint workshops on Intelligent Methods for Software System Engineering	Building 16 TD16.46	14:15-17:30
WS28	Planning to Learn (PlanLearn 2012)	Building 16 TD16.50	14:00-17:00
WS32	Acquisition, Representation and Reasoning with Contextualized Knowledge, 4th International Workshop (ARCOE-12)	Polytech TD011	14:00-17:00
WS34	WL4AI: Weighted Logics for AI	Polytech TD115	14:00-17:30
WS35	3rd International Workshop on Combinations of Intelligent Methods and Applications (CIMA-12)	Polytech SC104	14:00-17:00
WS37	3rd International Workshop on Artificial Intelligence and Logistics (AILog)	Polytech SC105	13:30-17:00
WS44	Intelligent Agents in City Simulations and Smart Cities	Polytech TD015	14:00-17:00

ECAI 2012

20TH EUROPEAN CONFERENCE ON ARTIFICIAL INTELLIGENCE

	Monday 27 th	Tuesday 28 th
RuleML	Location: IAE Amphi	
STAIRS	Location: IAE Room TD 11	

ECAI 2012

20TH EUROPEAN CONFERENCE ON ARTIFICIAL INTELLIGENCE

Campus Map

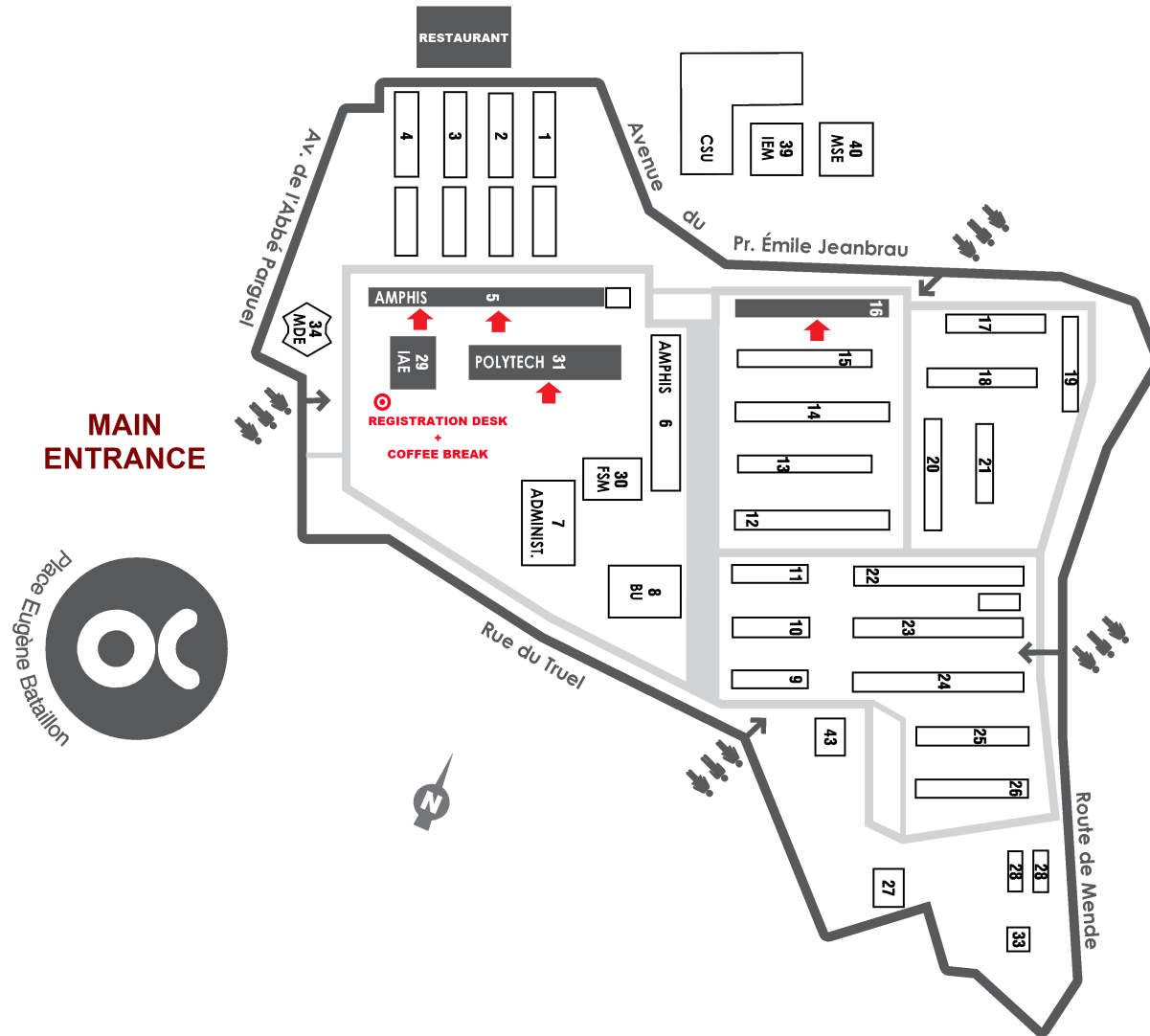

ECAI 2012

20TH EUROPEAN CONFERENCE ON ARTIFICIAL INTELLIGENCE

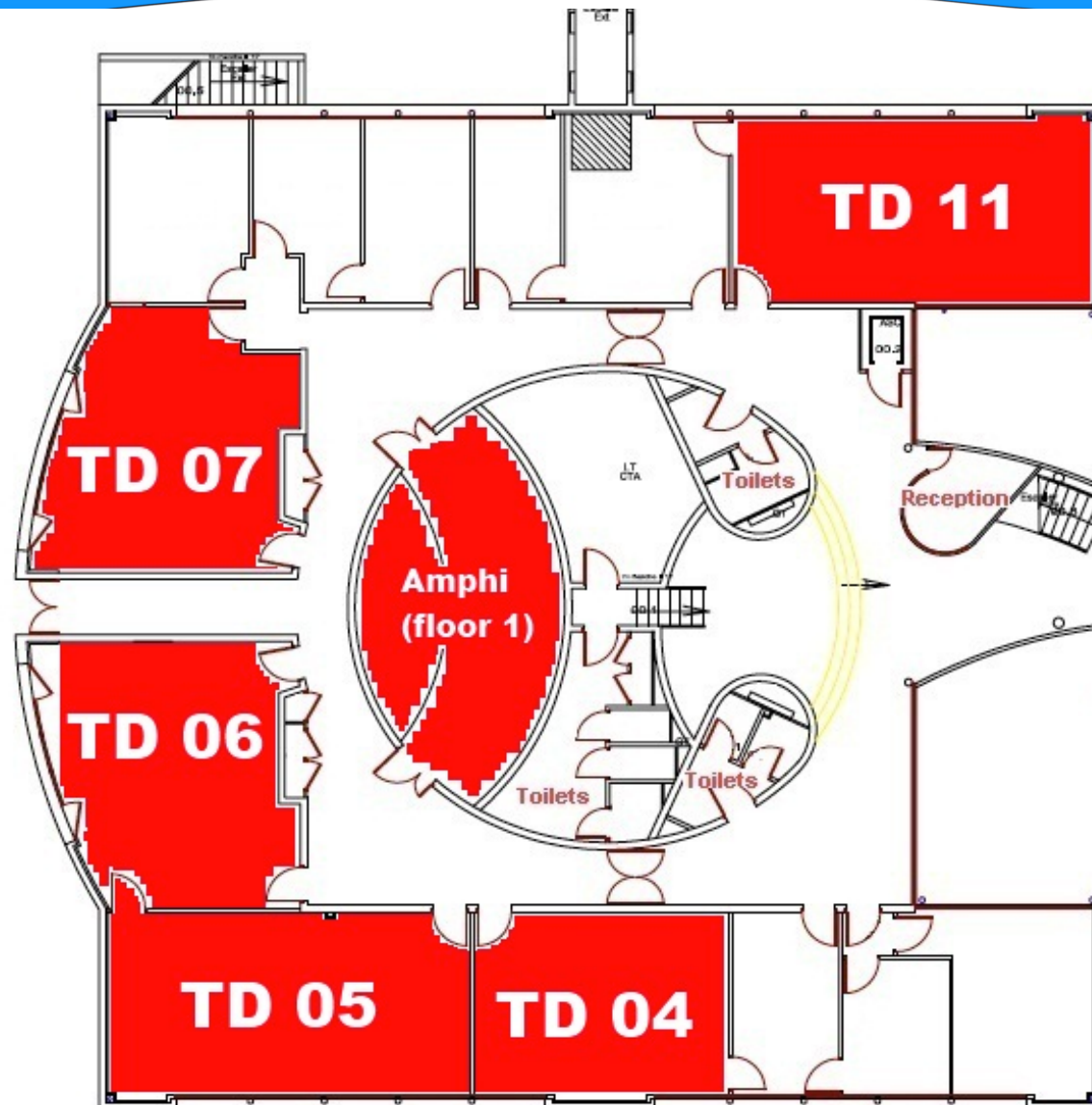

IAE Map

 **MAIN
ENTRANCE**

**REGISTRATION
DESK**



ECAI 2012

20TH EUROPEAN CONFERENCE ON ARTIFICIAL INTELLIGENCE

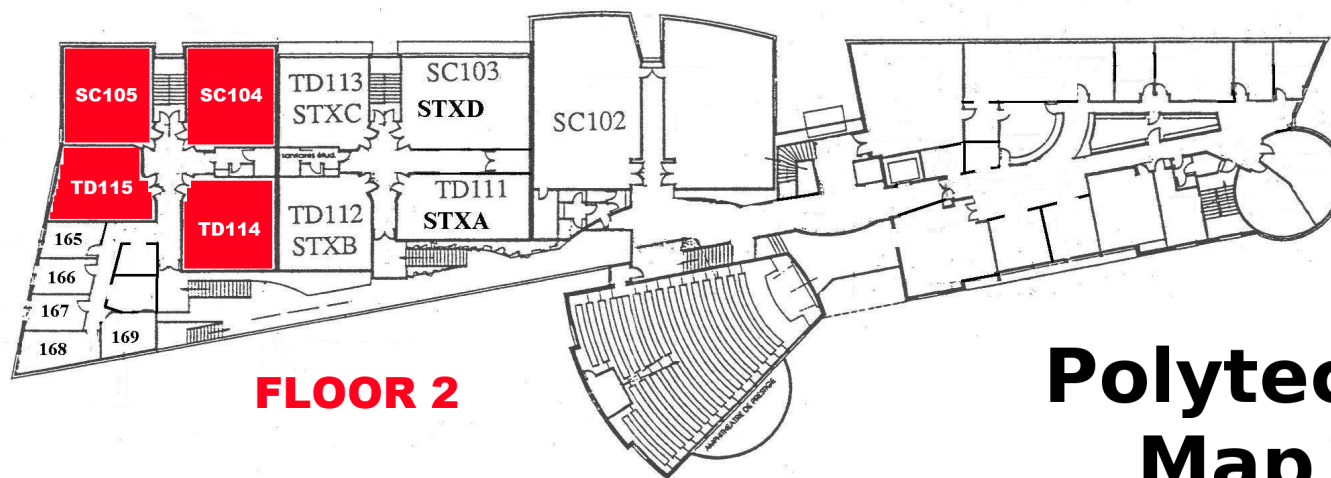

FLOOR 2

**Polytech
Map**

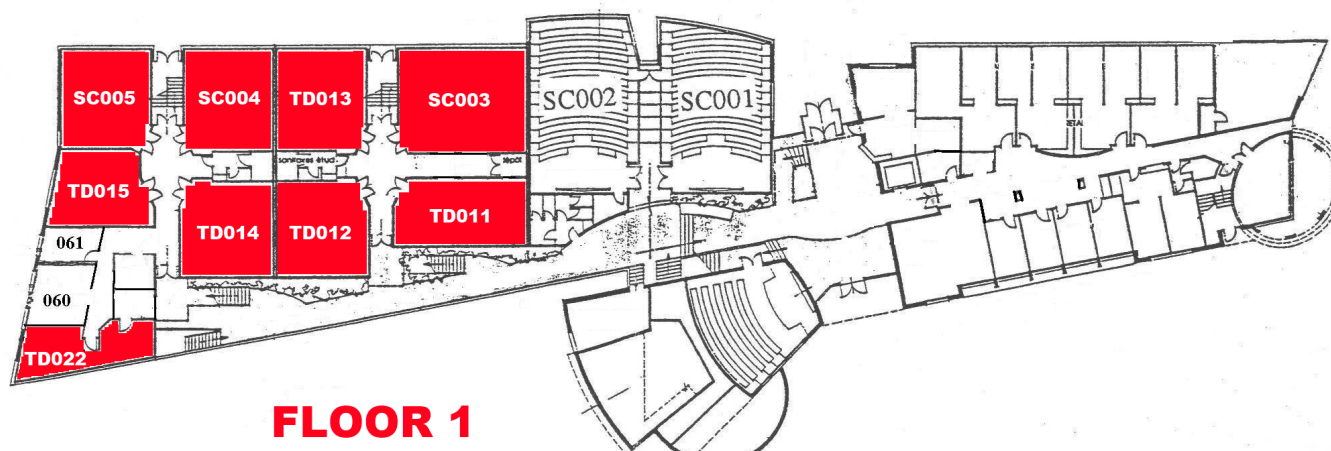

FLOOR 1

ECAI 2012

20TH EUROPEAN CONFERENCE ON ARTIFICIAL INTELLIGENCE

WIFI ACCESS INFORMATION		
<i>Building</i>	<i>Network</i>	<i>Password</i>
IAE Building	UM2-IAE-INTERVENANTS	9cc4defd7d
Polytech Building	POLYTECH-CONGRES	2428082012
Building 5	WIFI-ADM-UM2	Login: ECAI15551 Password: wz86eq22
University Campus	WIFI-ADM-UM2	Login: ECAI15551 Password: wz86eq22